

VNH12-92W T10

12V 92 W/Cell 15min (22Ah / 20h)



Introduction

Samson VNH (high rate) series is primarily for heavy load discharge in short time backup especially in UPS applications. Designed with a high-density plate technology, the series battery is featured of high consistency, excellent performance and reliable standby service life.

Battery Features

- High rate output aimed at the UPS market
- Low self-discharge
- Fully tank formed plates
- Low impurity electrolyte
- Spill proof / leak proof
- Multi-position usage
- ABS case and cover VO upon request
- Very high purity lead

Electrical Specification

Design floating Life @ 25°C (77°F)	5 years
Design Life Cycles @ 50% D.O.D. (25°C)	600 Cycles
Nominal Capacity @ 25°C /77°F	
20 hour rate 1 A to 1.75V/cell	22 Ah
Watt @ 15min to 1.67V/cell	93.2 W/cell
Watt @ 10min to 1.67V/cell	120.9 W/cell
Internal Resistance	
(Fully charged battery @ 25°C /77°F)	8mΩ
Max. Discharge Current @ 25°C /77°F	320A (5S)
Short Circuit Current	380 A
Charge Methods: Constant voltage charge @ 25°C /77°F	
Cycle Use	14.7 ~ 14.9V
Max. Current	6.6 A
Max. Current for best battery life	5.2 A
Standby Use	13.6 - 13.8V
Operating Temperature Range	-30 ~ 50°C

Notes: battery voltage must be adjusted according to temperature.
Effect of temperature on float charge voltage: -3mV/ °C/Cell.

Self-Discharge

3% of capacity declined per month @ 25°C (77°F).

Typical Applications

- UPS/EPS (High rate)
- Emergency lighting
- High power backup supply
- Electric starting
- Emergency power supply

Certificates



Battery Picture & Terminal Layout

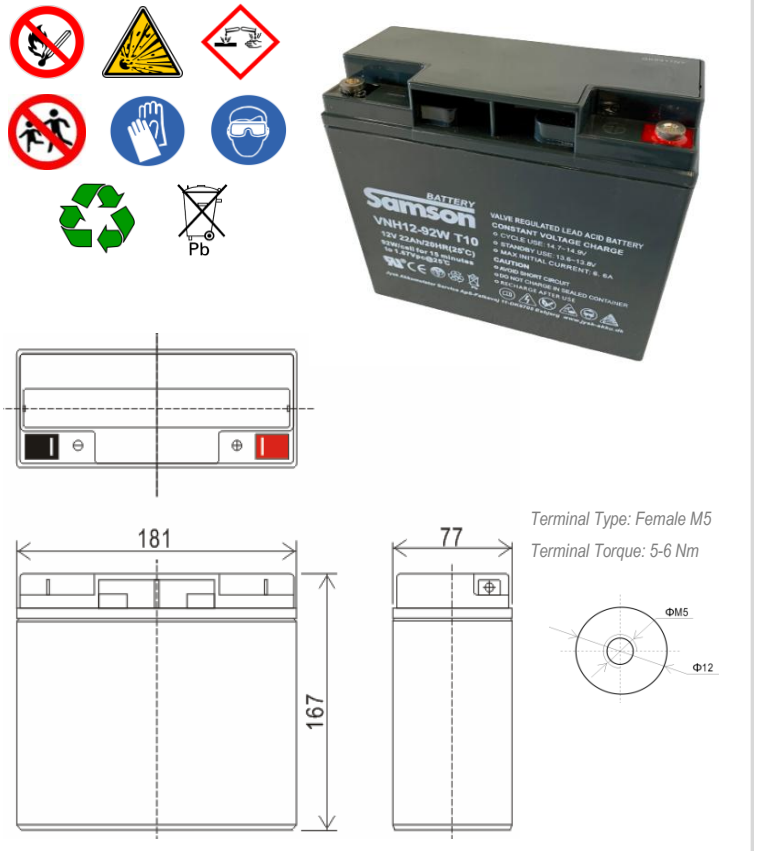

Dimension & Weight

Length	Dimension (± 2mm)			Total Height	Weight (± 2%)
	Width	Height	Height		
181 mm	77 mm	167 mm	167 mm	6,20 kg	
7,1 inch	3,0 inch	6,6 inch	6,6 inch	13,7 lbs	

Constant Current Discharge (Amperes @ 25°C /77°F)

V/cell	3min	5min	10min	15min	20min	30min	45min	1hr	2hr
1,60	-	128,14	71,53	52,87	43,67	30,99	21,03	16,51	9,09
1,65	-	123,21	68,89	52,56	42,74	30,64	20,99	16,29	9,07
1,70	-	120,59	67,63	51,67	42,67	30,42	20,93	16,21	8,99
1,75	-	110,08	64,64	49,98	41,61	30,14	20,88	16,17	8,89
1,80	-	99,47	59,50	47,34	39,65	29,19	20,31	15,90	8,78

Constant Power Discharge (Watts/cell @ 25°C /77°F)

V/cell	3min	5min	10min	15min	20min	30min	45min	1hr	2hr
1,60	-	208,8	124,6	94,5	79,11	58,24	41,65	33,80	19,26
1,65	-	203,6	123,5	93,7	78,62	58,02	41,31	33,69	18,84
1,67	-	199,4	120,9	93,2	77,24	57,11	41,23	33,49	18,48
1,70	-	190,4	117,9	92,0	76,60	56,39	40,53	33,03	17,90
1,75	-	184,4	113,9	91,2	74,97	55,94	40,15	32,41	17,27
1,80	-	163,2	105,1	86,1	72,98	55,75	39,60	31,64	16,89

Above discharge data (Amps/watts) is average values after batteries are fully charged.

Other relevant information

Contry of origin: **China** HS Code (harmonized system code): **85 07 20 00**
UN-Transport declaration: **UN2800** Customs tariff number **8507 10 20 80**

Subject to revision without notice. Please contact our sales representatives for latest version.

Web: www.jysk-akku.dk

E-mail: jvba@jysk-akku.dk

Version No.: 12-08-2021

VNH12-92W T10

12V 92 W/Cell 15min (22Ah / 20h)



Graphs

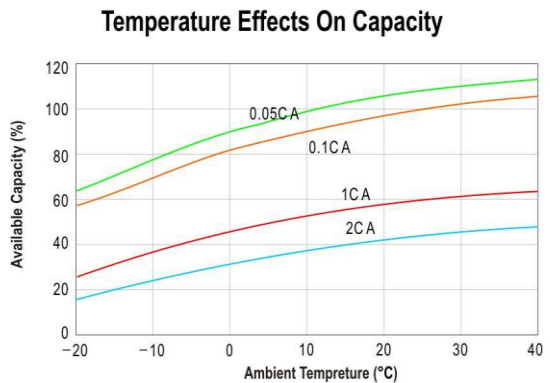
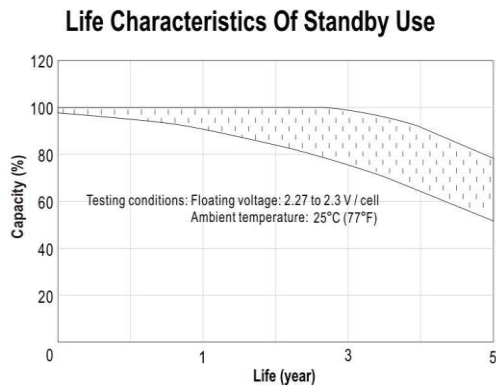
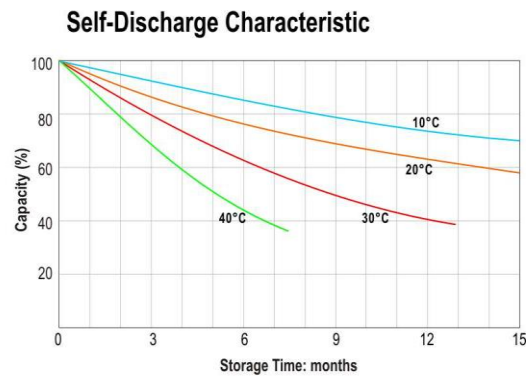
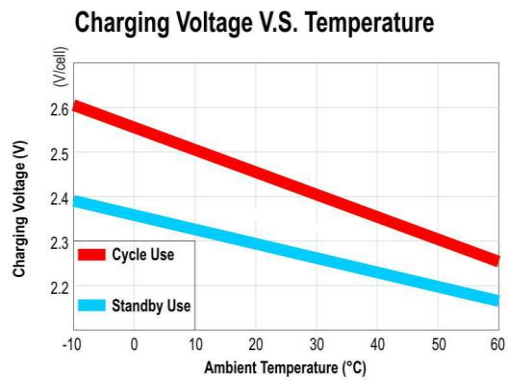
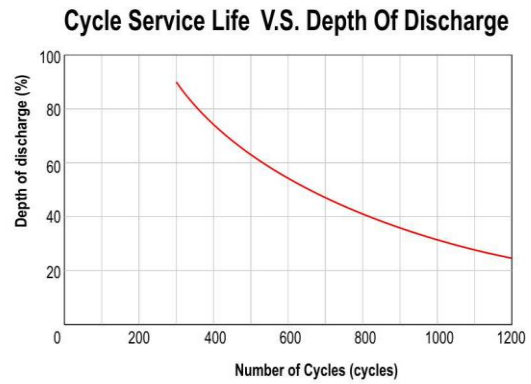
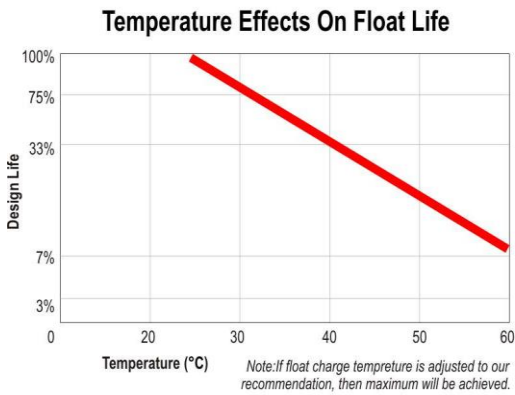
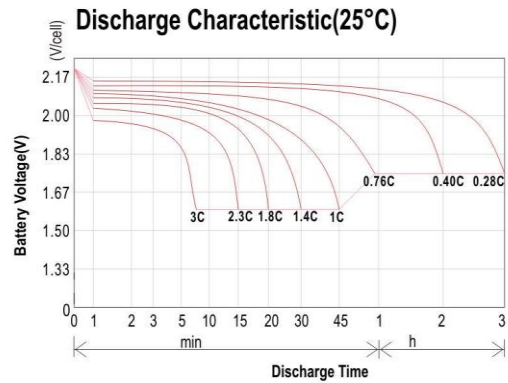
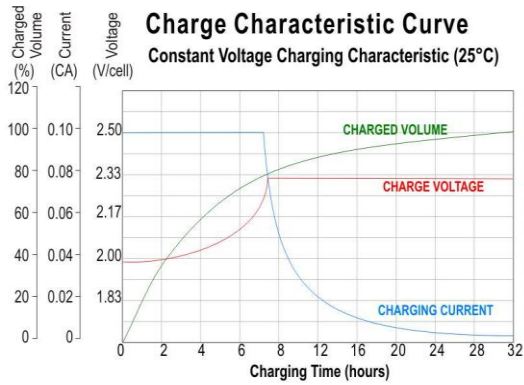

Subject to revision without notice. Please contact our sales representatives for latest version.

Web: www.jysk-akku.dk

E-mail: jvba@jysk-akku.dk

Version No.: 12-08-2021